



Khyam Swift Pitch DL

Instructions

Safety First

- Never use combustible fuels inside your tent.
(Gas/Petrol/Mentholated Spirits etc - lights/cookers/heaters)
Remember tents can burn.
- Do not smoke.
- Do not use naked flames except in designated cooking areas.
Try to locate this tent at least 6 m from other campers.
- Know the site's safety procedures
Keep all exits clear.
Camp Safely.

Before Use

- Please check the contents, erect and pitch your tent fully before embarking on your first camping holiday. In the unlikely event of finding any manufacturing defects or missing items please rectify this with your local dealer before going away.
- Be careful to avoid pitching your tent over sharp stones etc as this may damage the groundsheets. Pitching under trees may cause the flysheet to be contaminated with sap, this is not only impossible to remove but may also damage the flysheet.

Tent Limitations

Tents are designed to be lightweight and packable and therefore require care and understanding in their use. Whilst the outer Flysheet is waterproof, driving rain can, in some cases, cause water ingress around vents, zips and seams. You will get a certain amount of condensation build up. This is caused by the relatively warmer, humid air inside the tent making contact with colder outer fabric of your tent. This should not be confused with leakage. Please take particular care when assembling your tent in windy conditions. Ensure you have others to help you. If you overstress poles, they will break.

Your local retailer can supply replacement / spare pole sections. Always pitch your tent securely and ready for all weather conditions using all pegs and guys. The standard pegs supplied with this tent are suitable for normal ground conditions, however rocky, boggy, sandy or loose soil may require specialist pegs which are available through your local retailer. It is advisable to have some of these pegs to hand for use should you encounter such ground conditions on your trip. Never push pegs in by hand use a wooden or rubber faced mallet. Make sure your tent and personal belongings are insured. We accept no liability for consequential damage. Storm damage is not covered under our guarantee. Never pack your tent away wet or store your tent in a wet or damp conditions, it will get mildew. If you have to pack down in the rain ensure the tent is thoroughly dry before repacking.

Assembly (Steps 1 to 6)

Simply unzip and remove the tent from the carry bag. Slide the elastic webbing retaining band to one side so the elastic loop releases and gently through the tent into the air. Once the tent has opened fully, reposition, peg and guy securely.



To fold down (Steps 7 to 15) – un peg and follow the sequence shown

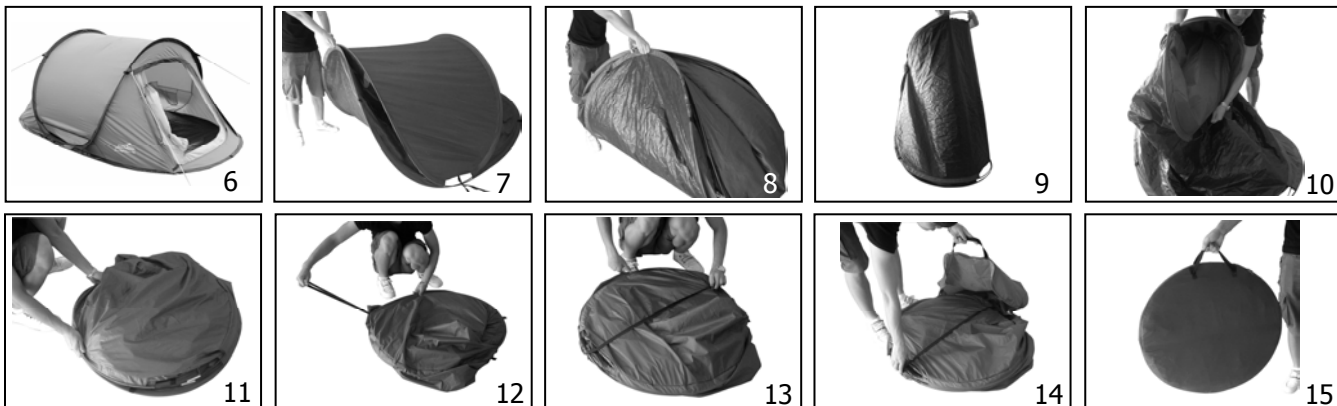

After Care

Always clean off mud and grass before packing. Always dry your tent thoroughly before storing. Store in dry well ventilated conditions. Treating the outer fabric with a proofing spray at regular intervals will prolong the life of your tent.